

Summary

Land (EXCL. HOTEL) ±83.3 AC ±3,630,496 SF
 Building (EXCL. OSA) 869,093 SF
 Land-to-Bldg Ratio 3.18/1
 Coverage 23.9%

Parking Provided 5,248 stalls
 Parking Ratio 6.04/1000



ALL SERVICES, APPROPRIATE, THEIR OCCUPANT AND THE USER AS SHOWN ON THE PLAN ARE PRELIMINARY AND SUBJECT TO MODIFICATION AT THE OWNER'S DISCRETION WITHOUT NOTICE. THIS PRELIMINARY SITE PLAN IS BASED ON INFORMATION FURNISHED TO NADDEL RETAIL ARCHITECTS LLP AND IS SUBJECT TO VERIFICATION OF ALL DIMENSIONS, SPACES AND COVERAGES. NADDEL ARCHITECTS LLP IS NOT RESPONSIBLE FOR THE ACCURACY OF ANY DIMENSIONS, SPACES OR OCCUPANCY OF ANY BUILDING WITHIN THIS CENTER.

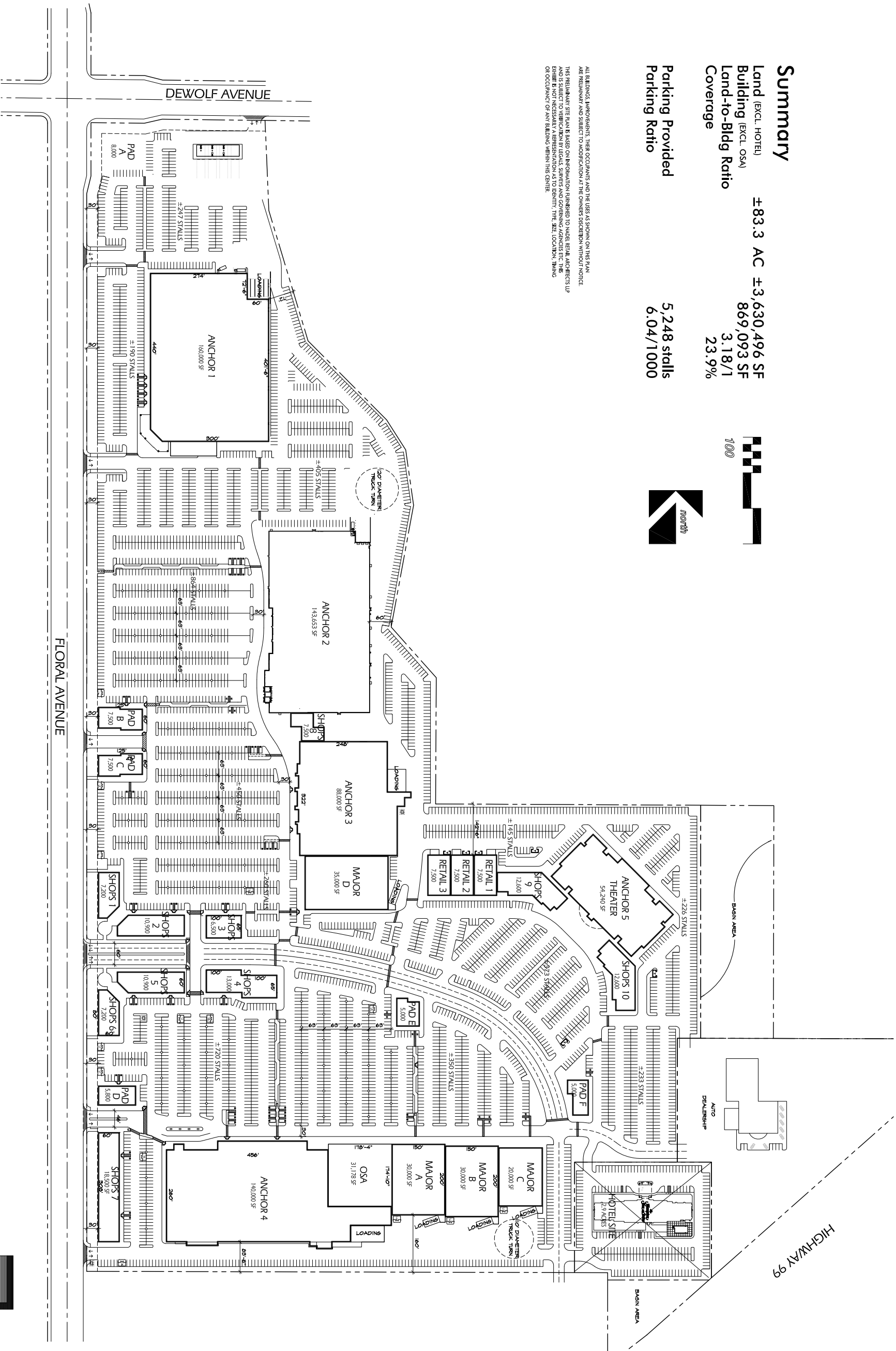

SITE PLAN - Scheme C1

POWER RETAIL CENTER SELMA, CA.

DATE: DEC. 11, 2009
 NADDEL JOB#: 09-453

NADDEL RETAIL ARCHITECTS, LLP
 1990 S. BUNDY DR., FOURTH FLOOR
 LOS ANGELES, CA, 90025
 T. 310.826.2100 F. 310.826.0182
 WWW.NADDEARC.COM

